

SUPER FORMULA CARS - C.025, C.026, C.048, C.050

Changed from RX Motor to Silver Motor late 1974

NOTE 1

View shows car in "upright" position. When reassembling ensure wires from motor to guide blade are as shown.

NOTE 2

Motor W.2030 has thinner shaft than Motor W.581 and therefore requires different Contrate Gear.

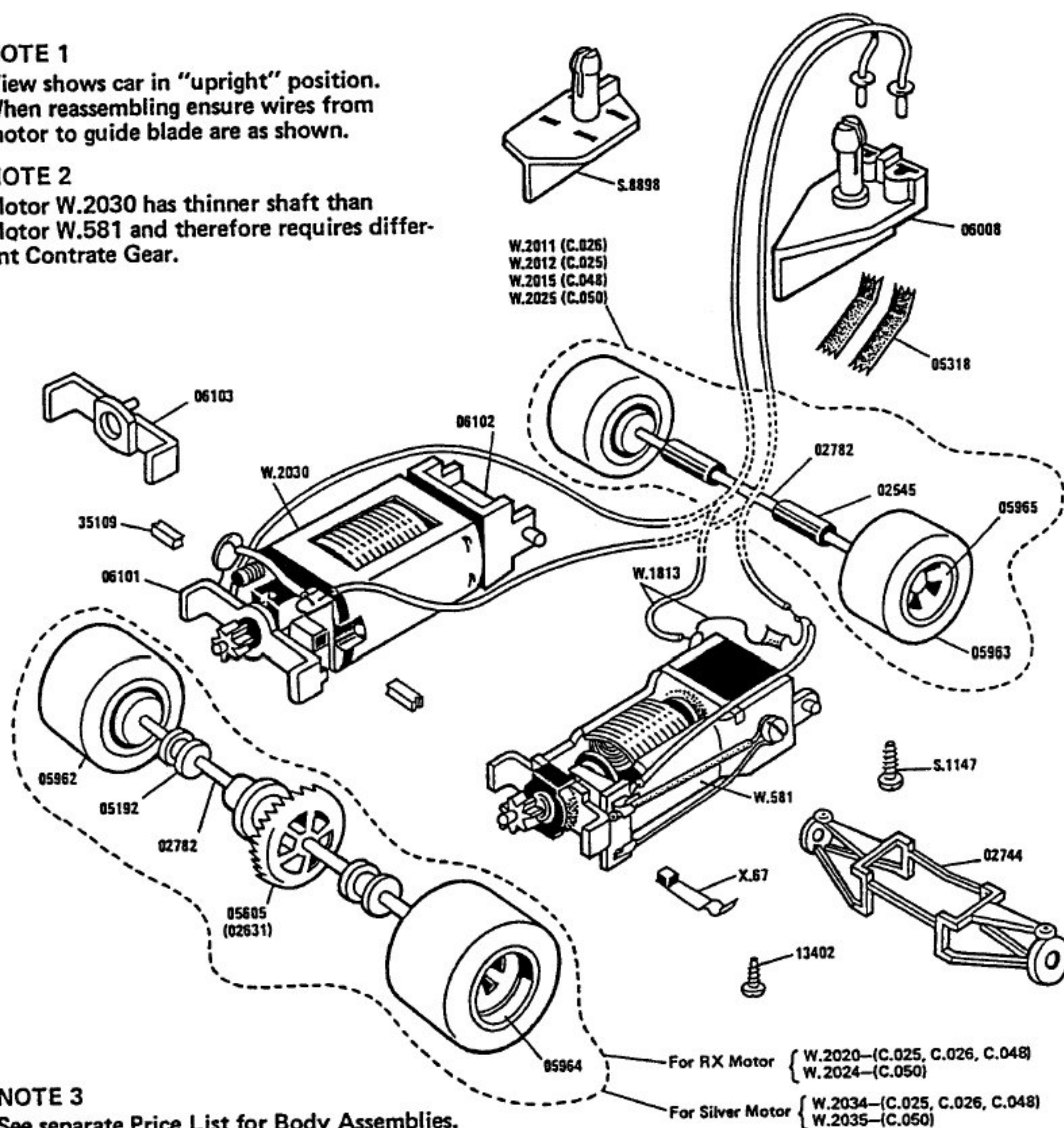

NOTE 3

See separate Price List for Body Assemblies.

W.581 RX Motor
W.1813 Wiring Harness
W.2011 Front Axle Assembly
W.2012 Front Axle Assembly
W.2015 Front Axle Assembly
W.2020 Rear Axle Assembly
W.2024 Rear Axle Assembly
W.2025 Front Axle Assembly
W.2030 Silver Motor with Wires
W.2034 Rear Axle Assembly
W.2035 Rear Axle Assembly

X.67 Carbon Brush (RX Motor)
S.1147 1/4" Body Screw
S.8898 Guide Blade (C.048)
02545 Front Axle Spacer
02631 Contrate Gear (Silver Motor)
02744 Suspension (C.026)
02782 Axle
05192 Axle Bearing
05318 Pick-up Braid

05605 Contrate Gear (RX Motor only)
05962 Rear Tyre
05963 Front Tyre
05964 Rear Hub
05965 Front Hub
06008 Guide Blade
06101 Motor Bracket A (Silver Motor)
06102 Motor Bracket B (Silver Motor)
06103 Motor Bracket C (C.048)
13402 1/4" Body Screw
35109 Carbon Brush (Silver Motor)

Modifications are made to models from time to time. If a spare part is required which does not coincide with the illustration, a full description should be given and, if necessary, a sketch or sample should accompany the order.